



OFFERS OVER

£79,500

Avon View

Strathaven, ML10 6GG

PROPERTY SUMMARY

Presented to the market in truly wall-in condition is this spacious, modernised, ground floor, flat. Conveniently located a short walk away from the Common Green where a variety of shops, restaurants, bars, and the 3C bus stop to Glasgow can be found. Offering generous, freshly floored and decorated, all on the level accommodation, private parking, and secure entry, this lovely flat is sure to appeal to first time buyers and downsizers alike.

The well-presented layout of accommodation comprises; communal secure entry close, reception hallway with storage, bright, front facing lounge, fitted kitchen with ample space for table and chairs, two well-proportioned bedrooms, the larger of the two having fitted wardrobes, and a stylish, modern shower room.

This fabulous property further benefits from double glazing, electric heating, communal grounds, and private allocated parking.

2

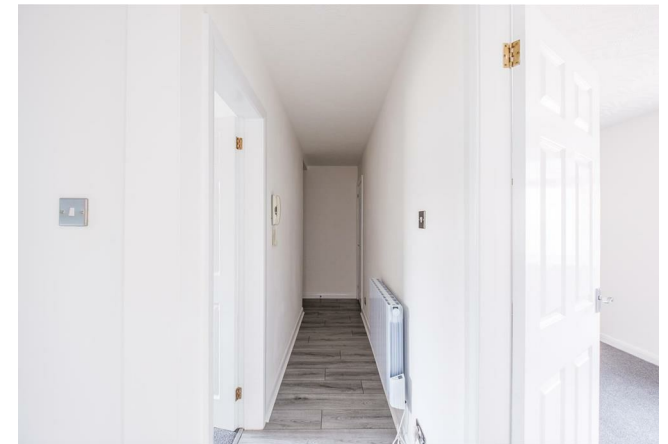







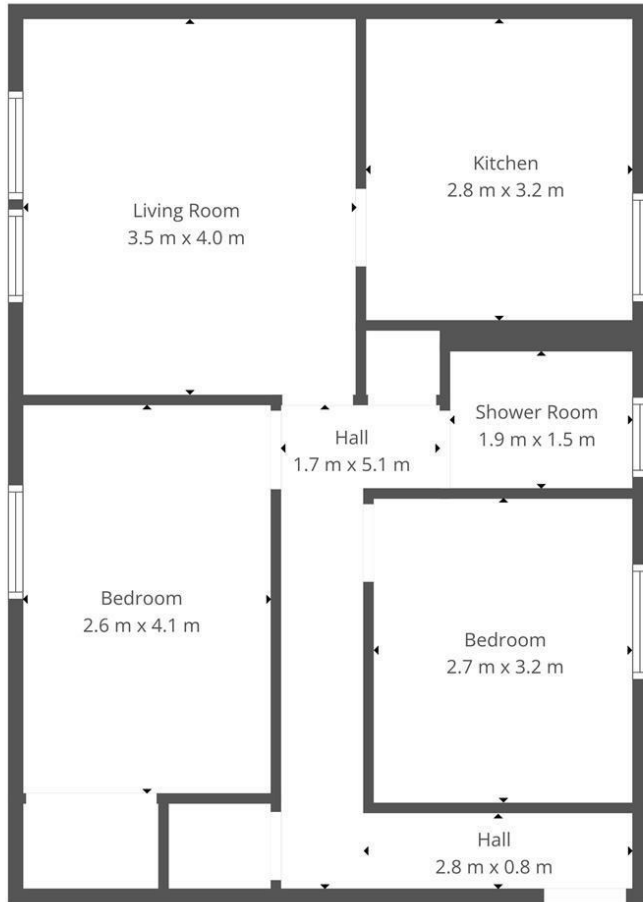

This Floorplan Is Intended To Give An Indication Of The Layout Only.

LOCAL AUTHORITY

South Lanarkshire

TENURE

Freehold

COUNCIL TAX BAND

C

VIEWINGS

By prior appointment only

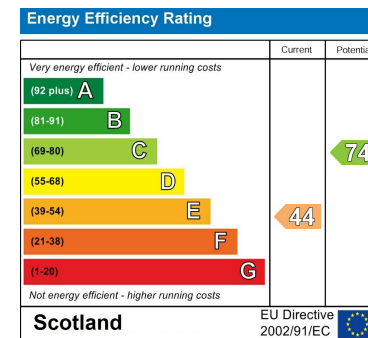

Agents Note: Whilst every care has been taken to prepare these particulars, they are for guidance purposes only. All measurements are approximate and are for general guidance purposes only and whilst every care has been taken to ensure their accuracy, they should not be relied upon and potential buyers/tenants are advised to recheck the measurements



OFFICE ADDRESS

9 Townhead Street
Strathaven
ML10 6AB

OFFICE DETAILS

01357 510088
judithmcgill@cruive-estateagents.co.uk